

ELECTRICAL & TELECOMMUNICATIONS DUCTING & CONDUIT

• PVC & POLYETHYLENE SYSTEMS •



PVC RIGID ELECTRICAL CABLE DUCT

Iplex PVC electrical cable ducts are “rigid conduits” as defined in AS / NZS 2053.1.

They are intended for durable underground installation using conventional open cut trench methods, to identify and protect contained underground electrical cables. If used unprotected from the sun above ground, UV / weathering resistance of the duct will be limited and colour fading (whitening), with some loss of impact strength will occur over time.

- DN 80, 100 and 150mm NB ducts colored orange are manufactured in accordance with AS/NZS 2053.2:2001 “Conduits and fittings for electrical installations - Part 2: Rigid plain conduits and fittings of insulating material”
- DN 32, 40 and 50 NB ducts colored orange are manufactured to the OD and wall thickness dimensions of AS / NZS 1260:2009



2700.50.6 SOE



2700.100HD.6SOE

Technical data and product range available:

Nominal Diameter (mm)	Iplex Order Code	*Classification	Colour	#Joint Type	Outside Diameter (mm)	Wall Thickness (mm)
32mm	2700.32.6 SOE	N.A.	Orange	Spigot/Socket SCJ	36.2 – 36.4	2.1 – 2.4
40mm	2700.40.6 SOE	N.A.	Orange	Spigot/Socket SCJ	42.9 – 43.1	2.0 – 2.6
50mm	2700.50.6 SOE	N.A.	Orange	Spigot/Socket SCJ	55.8 – 56.0	2.2 – 2.6
80mm	2700.80LD.6 SOE	Light duty	Orange	Spigot/Socket SCJ	82.3 – 82.7	2.2 – 2.6
100mm	2700.100LD.6 SOE	Light Duty	Orange	Spigot/Socket SCJ	110.0 – 110.4	2.9 – 3.4
150mm	2700.150LD.6 SOE	Light Duty	Orange	Spigot/Socket SCJ	160.0 – 160.5	4.2 – 4.8
100mm	2700.100HD.6 SOE	Heavy Duty (SN40)	Orange	Spigot/Socket SCJ	110.0 – 110.4	5.7 – 6.5
150mm	2700.150HD.6 SOE	Heavy Duty (SN40)	Orange	Spigot/Socket SCJ	160.0 – 160.5	8.3 – 9.3

*Classification: as depicted in Table 101, AS/NZS 2053.2:2001

SCJ = Solvent Cement Joint

PVC RIGID ELECTRICAL CONDUIT

Iplex PVC Electrical Conduits are “pliable conduits” as defined in AS/NZS 2053.2:2001

They are colored either orange or grey and intended for durable above-ground installation inside commercial and domestic buildings, to identify and protect contained electrical wiring or cables.

If used unprotected from the sun above ground, UV / weathering resistance of the conduit will be limited and colour fading (whitening), with some loss of impact strength will occur over time.

- 20mm, 25mm, 32mm, 40mm and 50mm NB PVC conduits colored orange or grey are manufactured in accordance with AS/NZS 2053.2:2001 “Conduits and fittings for electrical installations - Part 2: Rigid plain conduits and fittings of insulating material” – Medium Duty



2800.25.4 SOE (Grey)



2800.25.4 SOE (Orange)

Technical data and product range available:

Nominal Diameter (mm)	Iplex Order Code	*Classification	Colour	#Joint Type	Outside Diameter (mm)	Wall Thickness (mm)
20mm	2800.20.4 SOE	Medium Duty	Grey	Spigot/Socket SCJ	19.7 – 20.0	1.8 – 2.1
25mm	2800.25.4 SOE	Medium Duty	Grey	Spigot/Socket SCJ	24.7 – 25.0	1.8 – 2.1
32mm	2800.32.4 SOE	Medium Duty	Grey	Spigot/Socket SCJ	31.7 – 32.0	2.1 – 2.4
40mm	2800.40.4 SOE	Medium Duty	Grey	Spigot/Socket SCJ	39.7 – 40.0	2.4 – 2.7
50mm	2800.50.4 SOE	Medium Duty	Grey	Spigot/Socket SCJ	49.7 – 50.0	2.8 – 3.1
20mm	2850.20.4 SOE	Medium Duty	Orange	Spigot/Socket SCJ	19.7 – 20.0	1.8 – 2.1
25mm	2850.25.4 SOE	Medium Duty	Orange	Spigot/Socket SCJ	24.7 – 25.0	1.8 – 2.1
32mm	2850.32.4 SOE	Medium Duty	Orange	Spigot/Socket SCJ	31.7 – 32.0	2.1 – 2.4
40mm	2850.40.4 SOE	Medium Duty	Orange	Spigot/Socket SCJ	39.7 – 40.0	2.4 – 2.7
50mm	2850.50.4 SOE	Medium Duty	Orange	Spigot/Socket SCJ	49.7 – 50.0	2.8 – 3.1

*Classification: as depicted in Table 101, AS/NZS 2053.2:2001

SCJ = Solvent Cement Joint

PVC TELECOMMUNICATION DUCTING (Chorus Branded)

(Sold only to Chorus approved installers*)

Iplex Pipeline's range of PVC telecommunication ducting is available for telecommunication projects requiring cable protection

* Only approved Chorus Contractors can purchase and install these products. For further details please contact Iplex Pipelines.



20mm Telecommunications Duct (Chorus branded)

Size	Iplex Order Code	Colour	Joint Type	Outside Diameter (mm)	Wall Thickness (mm)
20mm x 6m	10012937	Green	Spigot/Socket, SCJ	26.6 – 26.9	1.3 – 1.6
20mm x 6m	10013281	White	Spigot/Socket, SCJ	26.6 – 26.9	1.3 – 1.6
50mm x 6m	P4001	Green	Rubber Ring Joint	60.2 – 60.5	2.4 – 2.9
100mm x 6m	P4000	Green	Rubber Ring Joint	110.0 – 110.4	2.7 – 3.3

PVC TELECOMMUNICATION REPAIR SLEEVE (Chorus Branded)

Size	Iplex Order Code	Colour	Joint Type	Internal Diameter (mm)	Wall Thickness (mm)
50mm x 2m	10013103	Green	Plain end, SCJ	60.5	2.4 – 2.9
100mm x 2m	10013102	Green	Plain end, SCJ	110.4	2.7 – 3.3

Repair sleeve slides over the outside of the PVC telecommunication duct, and is joined to the duct with PVC solvent cement.



100mm PVC Repair sleeve



50mm PVC Repair sleeve



100 mm green PVC Telecommunication ducts, showing horizontal separation in the trench space from other services such as telecommunications (green and purple), potable water (white) and gas (yellow)
Also trench wall is marked to locate backfill compaction zones above the pipes

COILED PE TELECOMMUNICATION DUCT (Chorus Branded)

ORDER CODE	COLOUR	SIZE mm	COIL LENGTH m
20021793	GREEN	20mm	200m
10012829	BLACK with RED TRI-STRIPE	32mm	1000m
10012829500	BLACK with RED TRI-STRIPE	32mm	500m
10012830	BLACK with GREEN TRI-STRIPE	32mm	1000m
10012830500	BLACK with GREEN TRI-STRIPE	32mm	500m
10012831	BLACK with VIOLET TRI-STRIPE	32mm	1000m
10012831500	BLACK with VIOLET TRI-STRIPE	32mm	500m
10012832	BLACK with BROWN TRI-STRIPE	32mm	1000m
10012832500	BLACK with BROWN TRI-STRIPE	32mm	500m



100m Coils – PE telecommunication duct SDR17



DN 32 PE sub- ducts inside 100mm PVC carrier ducts, at a roadside connection pit

PVC-U TELECOMMUNICATION BENDS (Chorus Branded)

ORDER CODE	COLOUR	SIZE mm
10012582	GREEN	20mm x 90° ROD* 240
10013280	GREEN	20mm x 90° ROD* 400
10012939	GREEN	20mm x 90° ROD* 530
10013279	WHITE	20mm x 90° ROD* 100
10012940	WHITE	20mm x 90° ROD* 300
10013084	GREEN	50mm x 30° ROD*350
10013087	GREEN	50mm x 45° ROD*200
10013086	GREEN	50mm x 45° ROD*350
10013100	GREEN	50mm x 45° ROD*900
10013088	GREEN	50mm x 90° ROD*350
10013099	GREEN	50mm x 90° ROD*900
10013098	GREEN	100mm x 22° ROD*900
10013091	GREEN	100mm x 30° ROD*300
10013093	GREEN	100mm x 45° ROD*300
10011337**	GREEN	100mm x 90° ROD*350
10013095	GREEN	100mm x 90° ROD*400
10013094	GREEN	100mm x 90° ROD*600
10013096	GREEN	100mm x 90° ROD*900

*Radius of Diameter

**F&F Bend

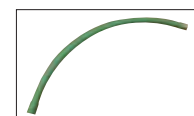

20MM FORMED BEND



50MM FORMED BEND M&F



100MM FORMED BEND M&F

PVC-U TELECOMMUNICATION FITTINGS (Chorus Branded)

ORDER CODE	COLOUR	SIZE mm
10013109	GREEN	50mm



COUPLER

ORDER CODE	COLOUR	SIZE mm
10012938	GREEN	50mm x 20mm



REDUCING SADDLE

ORDER CODE	COLOUR	SIZE mm
P4004	BLACK	50mm
P4005	BLACK	100mm



DUST CAP

COILED POLYETHYLENE ELECTRICAL DUCT

Iplex Pipeline's range of polyethylene cable ducting complements the use of trenchless installation methods, including Horizontal Directional Drilling, under roads and built up areas, or where conventional open cut trenching is impractical.

The available PE duct range conforms dimensionally to AS/NZS 4130, "PE Pipes for Pressure Applications", for SDR17 duct using PE80 (MDPE) materials.



Two DN 110 PE electrical ducts in 50m coils on a dual-coil dispensing trailer



DN 110 PE electrical ducts with pull heads in place, ready for pull-in by horizontal directional drilling

Technical data and product range available:

OD mm	Iplex Code	Colour	Coil Length	SDR Rating	Outside Diameter (mm)	Wall Thickness (mm)
32	CABLE DUCT OR 32/28.200	All Orange	200m	17	32.0 – 32.3	1.9 – 2.2
32	CABLE DUCT OR 32/28.500	All Orange	500m	17	32.0 – 32.3	1.9 – 2.2
63	CABLE DUCT OR 63/55.100	All Orange	100m	17	63.0 – 63.6	3.8 – 4.3
63	CABLE DUCT OR 63/55.150	All Orange	150m	17	63.0 – 63.6	3.8 – 4.3
90	CABLE DUCT OR 90/79.50	All Orange	50m	17	90.0 – 90.9	5.4 – 6.1
90	CABLE DUCT OR 90/79.100	All Orange	100m	17	90.0 – 90.9	5.4 – 6.1
110	CABLE DUCT OR 110/97.50	All Orange	50m	17	110.0 – 111.0	6.6 – 7.4
110	CABLE DUCT OR 110/97.100	All Orange	100m	17	110.0 – 111.0	6.6 – 7.4
125	CABLE DUCT OR 125/110.100	All Orange	100m	17	125.0 – 126.0	7.4 – 8.3

COILED POLYETHYLENE TELECOMMUNICATION DUCT

Iplex Pipeline's ability to color or color-stripe polyethylene ducting, assists the duct asset owner with identification in multiple duct applications.



DN 32 PE telecommunication duct in a 500m coil on a coil dispensing trailer



DN 110mm PE telecommunication duct in a 100m coil on a coil dispensing trailer

COILED PE TELECOMMUNICATION DUCT SDR 17 (GREEN)

Technical data and product range available:

O.D	Iplex Code	Colour	Coil Length	SDR Rating	Outside Diameter (mm)	Wall Thickness (mm)
32	TELEDUCT PE32/28.200	Lime Green	200m	17	32.0 – 32.3	1.9 – 2.2
32	TELEDUCT PE32/28.500	Lime Green	500m	17	32.0 – 32.3	1.9 – 2.2
63	TELEDUCT PE63/55.100	Lime Green	100m	17	63.0 – 63.6	3.8 – 4.3
63	TELEDUCT PE63/55.150	Lime Green	150m	17	63.0 – 63.6	3.8 – 4.3
110	TELEDUCT PE110/97.50	Lime Green	50m	17	110.0 – 111.0	6.6 – 7.4
110	TELEDUCT PE110/97.100	Lime Green	100m	17	110.0 – 111.0	6.6 – 7.4

PVC-U TELECOMMUNICATION DUCT

ORDER CODE	COLOUR	SIZE MM
2780.100LD.6 SOE	GREEN	100 x 6
2730.50.6 SOE	RED	50 x 6
2730.100LD.6 SOE	RED	100 x 6



SOCKET ONE END

ELECTRICAL AND TELECOMMUNICATION FITTINGS

Iplex Pipelines has a range of PVC and polyethylene fittings for use with electrical and telecommunication ducting. The most common fittings are the post-formed bends. Other fittings, such as tees, y-junctions, couplers etc are available. For more information on these fittings contact Iplex Pipelines.

PVC-U ELECTRICAL CABLE DUCT BENDS (ORANGE)

ORDER CODE	COLOUR	SIZE MM
2703.50.45	ORANGE	50 x 45°
2703.50.90	ORANGE	50 x 90°
2703.80.45	ORANGE	80 x 45°
2703.80.90	ORANGE	80 x 90°
2703.100.45R250	ORANGE	100 x 45° ROD* 250mm
2703.100.90R250	ORANGE	100 x 90° ROD* 250mm
2703.100.90R900	ORANGE	100 x 90° ROD* 900mm

*Radius of Diameter

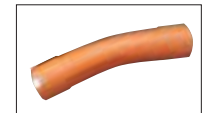

FORMED ELECTRICAL BEND F&F

PVC-U CABLE DUCT BENDS (WHITE)

ORDER CODE	COLOUR	SIZE MM
CD8032045	WHITE	20 x 45°
CD8032090	WHITE	20 x 90°



PIPE INSTALLATION GUIDELINES

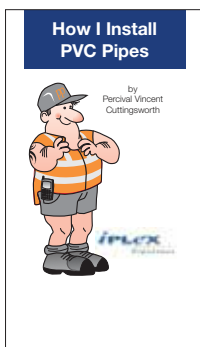

Refer to "How I install PVC Pipes"
Available at <http://www.iplex.co.nz>

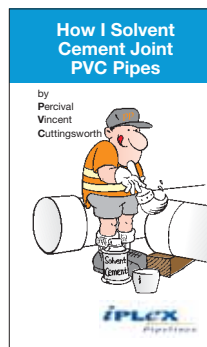

Refer to "How I solvent Cement Joint PVC Pipes"
available at <http://www.iplex.co.nz>

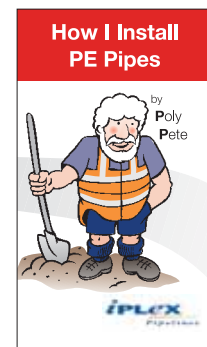

Refer to "How I Install PE Pipes"
available at <http://www.iplex.co.nz>

Product Range from Iplex Pipelines

NOVADRAIN & NOVACOR
PVC DRAIN WASTE & VENT SYSTEMS

RESTRAIN™
DRILLABLE PVC GRAVITY SEWER PIPE

POLIDRAIN™
POLYETHYLENE DRAINAGE SYSTEM

SUPERSTORM™ & STORMFIT
PVC STORMWATER DUCT SYSTEM

NEXUS™ HI-WAY
ROAD DRAINAGE SYSTEM

NOVAKEY™ & BLUE BRUTE
PVC-U PRESSURE SYSTEMS

WHITE & BLUE RHINO™
HIGH IMPACT PVC-M PRESSURE PIPE

APOLLO™ & APOLLOBLUE™
PVC-O PRESSURE PIPE

NOVAFUSE™
FUSIBLE PVC PIPE

BLUELINE & POLIPLX
MEDIUM DENSITY POLYETHYLENE PIPE

ALKATHENE™
LOW DENSITY POLYETHYLENE PIPE

NOVATUBE
HORTICULTURAL LATERAL TUBE

GREENLINE, REDLINE™, RURAL BLACK, BLACKLINE & BLACKLINE HP
POLYETHYLENE PRESSURE PIPE

PLASSON
METRIC COMPRESSION FITTINGS

NEXUS™FLO, NEXUS™COIL, NOVAFLO™ & NOVACOIL
LAND DRAINAGE SYSTEMS

IPLEX EFFLUENT PIPE
MEDIUM DENSITY POLYETHYLENE PIPE

FARMTUFF™ & NEXUS™ CULVERT
CULVERT PIPE

POLIGAS™
POLYETHYLENE GAS SYSTEMS

© 2016 IPLEX PIPELINES (NZ) LIMITED. NEXUS™, IPLEX™, RESTRAIN™, APOLLO™, NOVAFLO™, FARMTUFF™, NOVAKEY™, NOVAFUSE™, POLIGAS™, RHINO™, REDLINE™, POLYDRAIN™, SUPERSTORM™ are registered trademarks of IPLEX PIPELINES (NZ) LIMITED.
Version 2

This version supersedes all previous versions or editions of this brochure.

Important Disclaimer

The information, opinions, advice and recommendations contained in this publication are put forward with the main objective of providing a better understanding of technical matters associated with pipeline design using Iplex Pipelines. Whilst all reasonable care has been made in ensuring that the information contained in this publication is accurate, this publication should not be used as the only source of information by the reader. Reference should also be made to established textbooks and other published material, and readers should not rely on the information contained in this publication without taking appropriate professional advice for their particular circumstances. Pipes and fittings have been shown as typical configurations, however, in some cases product dimensions may vary or be changed without notice. In all instances, the reader should contact Iplex Pipelines for clarification that the specific product is appropriate for their circumstances.

Iplex Pipelines NZ Limited.

Call Centre –
Phone: 0800 800 262
Fax: 0800 800 804
Web: www.iplex.co.nz

Offices At:

Auckland: Private Bag 92 114, 810 Great South Road, Penrose.
Palmerston North: Private Bag 11019, 67 Malden Street.
Christchurch: PO Box 16225, 22 Braeburn Drive, Sockburn.

ELECTRICAL & TELECOMMUNICATIONS DUCTING & CONDUIT

• PVC & POLYETHYLENE SYSTEMS •