



## AVK GATE VALVE PN16 WITH SUPA PLUS™ COUPLING

01/71



To EN 1074-2  
With tensile Supa Plus™ coupling for PE-pipe  
For Polyethylene pipes PE100, PN16 - SDR11 to AS/NZ 4130



### Use:

- For water, sewage and neutral liquid applications
- Total angular deflection of  $\pm 3.5$  degrees per end
- For use in cold water applications

### Tests:

- Hydraulic test to AS 2638.2:
  - Seat: 16 Bar
  - Body: 24 Bar
  - Operating torque test



### Optional Extras:

- Handwheel
- Support Bush
- Purple Stem cap

AVK always recommend the Series 05 support bush be utilised when using Polyethylene pipe systems and AVK tensile resistant sealing ring (Supa Plus™) fittings and valves.



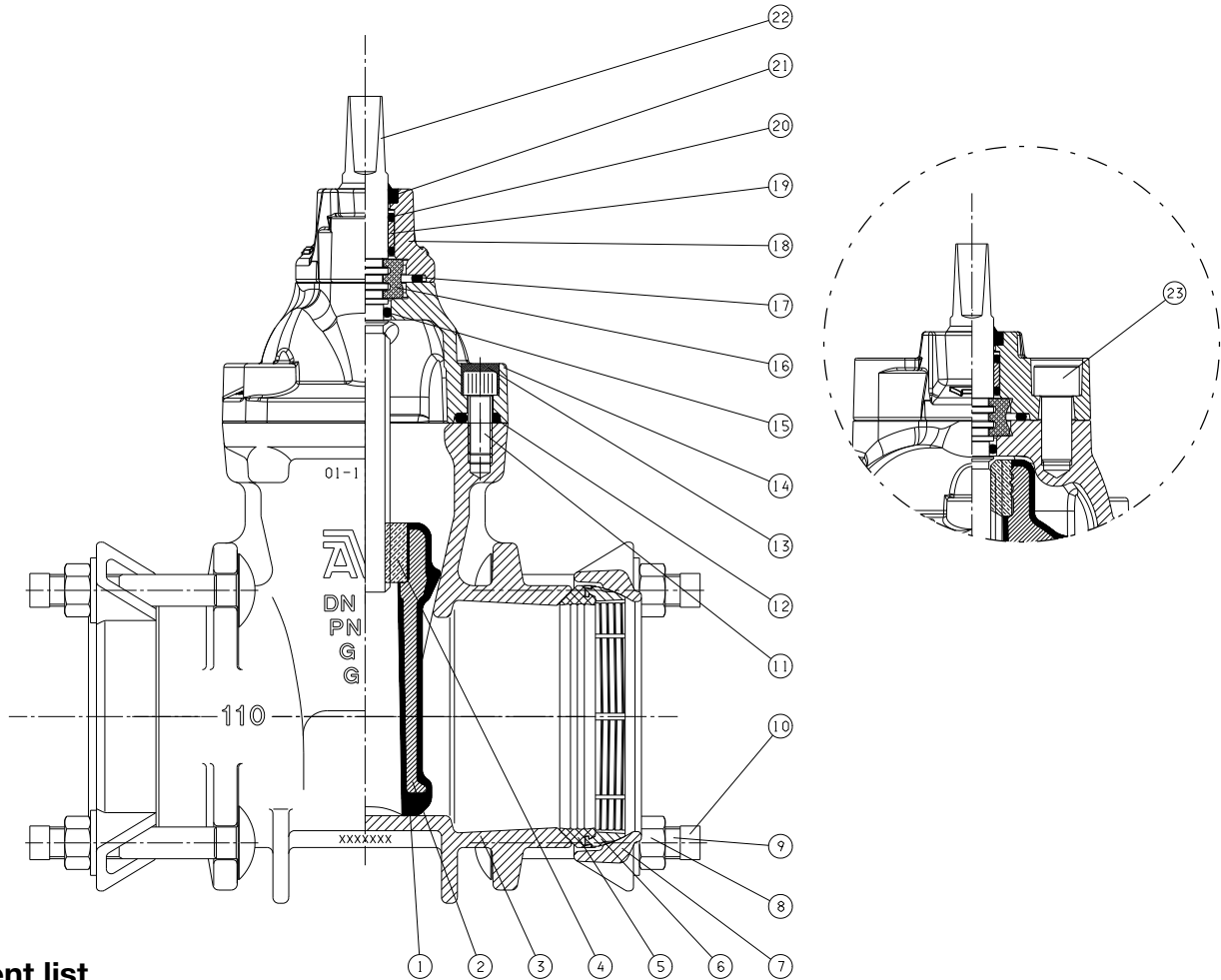

**Component list**

|                     |  |                      |                                 |
|---------------------|--|----------------------|---------------------------------|
| 1. Wedge rubber     | EPDM rubber  | 10. Cap              | Ductile Iron, 400-12 to AS 1831 |
| 2. Wedge casting    | Ductile Iron, 500-7 to AS 1831                       | 11. Bonnet bolt      | Grade 8.8, sealed with hot melt |
| 3. Body             | Ductile Iron GGG-40 to DIN 1693, EN-GJS:EN 1563 1998 | 12. Bonnet gasket    | EPDM                            |
| 4. Stem nut         |  | 13. Screw cover      |                                 |
| 5. Gasket           | EPDM   | 14. Bonnet           | Ductile Iron, 500-7 to AS 1831  |
| 6. Tensile ring     | Gunmetal DIN 17005 RG5 / EPDM rubber                 | 15. O-ring stem seal |                                 |
| 7. Bracket          | Ductile Iron GGG-40 to DIN 1693, EN-GJS:EN 1563 1998 | 16. Stem collar      |                                 |
| 8. Nut              | Stainless Steel (AISI 316) A4 grade 80 PTFE coated   | 17. Gland o-ring     |                                 |
| 9. Square neck bolt | Stainless Steel A2, grade 80                         | 18. Gland flange     | Ductile Iron, 500-7 to AS 1831  |
|                     |  | 19. Bushing          |                                 |
|                     |  | 20. O-ring           |                                 |
|                     |  | 21. Wiper ring       |                                 |
|                     |  | 22. Stem             | Stainless Steel 431             |

Components can be substituted with equivalent or higher class materials.

**Reference nos. and dimensions**

| AVK ref. nos.<br>CC | AVK ref. nos.<br>ACC | DN<br>mm | OD<br>PE | A<br>mm | E<br>mm | H<br>mm | L<br>mm | F<br>mm | Number<br>of bolts | Theoretic<br>Weight<br>kilos | Support Bush<br>PE100, PN1SDR11<br>ref. nos. |
|---------------------|----------------------|----------|----------|---------|---------|---------|---------|---------|--------------------|------------------------------|--|
| 01-090-7141412      | 01-090-7151412       | 80       | 90       | 78      | 68      | 297     | 200     | 17      | 2 x 2 M16          | 13                           | 05-090-54001                                 |
| 01-110-7141412      | 01-110-7151412       | 100      | 110      | 90      | 94      | 334     | 208     | 19      | 4 x 2 M16          | 18                           | 05-110-54001                                 |
| 01-125-7141412      | 01-125-7151412       | 125      | 125      | 91      | 102     | 375     | 208     | 19      | 4 x 2 M16          | 24                           | 05-125-54001                                 |
| 01-160-7141412      | 01-160-7151412       | 150      | 160      | 124     | 118     | 448     | 260     | 19      | 4 x 2 M16          | 56                           | 05-160-54001                                 |
| 01-180-7141412      | 01-180-7151412       | 150      | 180      | 124     | 128     | 448     | 260     | 19      | 4 x 2 M16          | 56                           | 05-180-54001                                 |
| 01-200-7141412      | 01-200-7151412       | 200      | 200      | 124     | 158     | 562     | 309     | 24      | 6 x 2 M16          | 58                           | 05-200-74001                                 |
| 01-225-7141412      | 01-225-7151412       | 200      | 225      | 133     | 172     | 562     | 309     | 24      | 6 x 2 M16          | 80                           | 05-225-54001                                 |
| 01-250-7141412      | 01-250-7151412       | 250      | 250      | 143     | 174     | 664     | 339     | 27      | 6 x 2 M16          | 95                           | 05-250-54001                                 |
| 01-280-7141412      | 01-280-7151412       | 250      | 280      | 155     | 184     | 664     | 339     | 27      | 6 x 2 M16          | 123                          | 05-280-54001                                 |
| 01-315-7141412      | 01-315-7151412       | 300      | 315      | 184     | 208     | 740     | 380     | 27      | 6 x 2 M16          | 246                          | 05-315-54001                                 |