



AVK LUG BUTTERFLY VALVE, CENTRIC WITH LOOSE LINER PN16

76/71

Centric butterfly valve with loose liner designed according to EN 593 and AS 4795.1
Face to face according to EN 558-2008 Table 2 basic series 20, coating to AS 4158
Standard flange drilling to AS 2129 Table D / AS 4087 B5

Use:

- For water and neutral liquids to max. 70°C
- For cold drinking water application up to 90°C

Tests:

- Hydraulic test to AS 4795.1

Actuation:

- DN50-200 delivered with lever
- DN250-300 with wormgear

Approvals:

- WRAS drinking water approval

FLOW COEFFICIENT - K_V - AT FULLY OPEN VALVE POSITION

DN	NPS	K_V
50	2"	91
65	2 1/2"	206
80	3"	436
100	4"	660
125	5"	1300
150	6"	2100
200	8"	4100
250	10"	6090
300	12"	9570

Note: $C_V = 1.16 \times K_V$



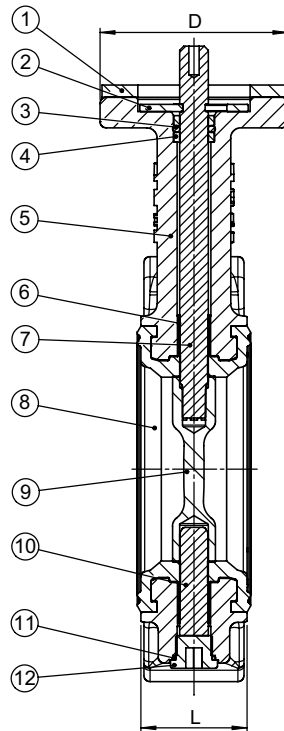
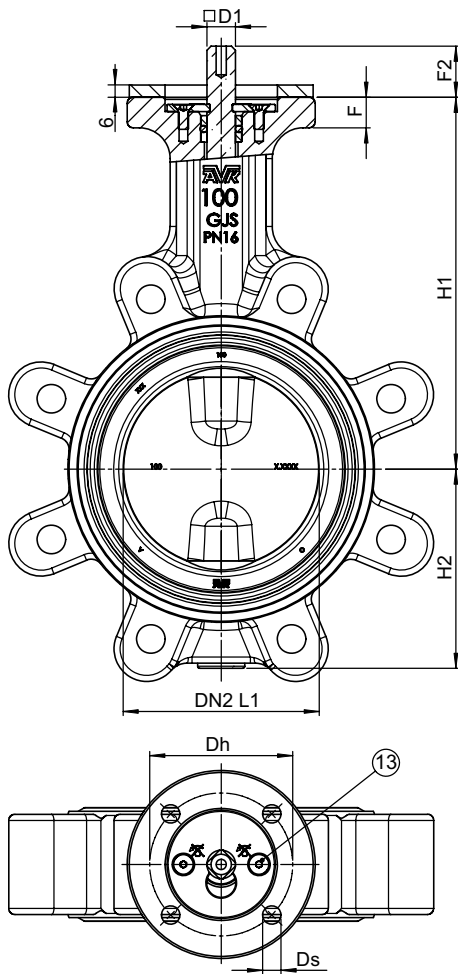

Centric design with loose liner

The centric design with loose rubber liner makes it possible to exchange the rubber liner to extend the valve's durability, and to apply epoxy coating electrostatically for improved corrosion resistance. The rubber liner provides resilient seal and a flattened seating area around the shaft giving optimum sealing. The 2 stub shaft results in a very slim disc featuring a very low pressure loss across the valve.

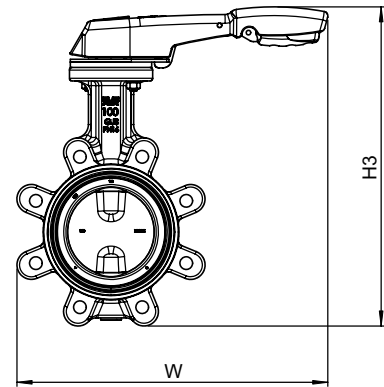

DN50-DN200 delivered with lever

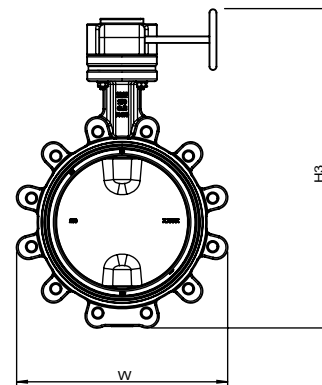

Component list

1. Dew point blocker	PP
2. Plate	POM
3. O-ring	EPDM (item 3) / NBR (item 11)
4. Ring	POM
5. Body	Ductile Iron EN 1563 EN-GJS-500/7
6. Bearing	Steel/PTFE
7. Drive Shaft	Stainless Steel EN 10088 No. 1.4021 / AISI 420
8. Loose liner	EPDM with WRAS drinking water approval
9. Disc	Stainless Steel EN 10088 No. 1.4408
10. Stub Shaft	Stainless Steel 431
11. O-ring	EPDM (item 3) / NBR (item 11)
12. Plug	POM
13. Countersunk Screw	Stainless Steel A2

Components can be substituted with equivalent or higher class materials.

Reference nos. and dimensions

AVK ref. nos.	DN mm	PN rating	DN2L1 mm	L mm	F mm	F2 mm	D mm	D1 mm	Dh mm	Ds mm	H1 mm	H2 mm	W mm	H3 mm	Theoretical weight kg
76-0050-71-838040690305	50	AS2129D	48	43	12	18	67	9	50	7	125	65	254	252	3.3
76-0065-71-838040690305	65	AS2129D	63	46	12	18	67	9	50	7	150	78	261	290	4.1
76-0080-71-838040690305	80	AS2129D	77	46	12	18	67	9	50	7	157	85	284	309	5.4
76-0100-71-838042690305	100	AS2129D	96	52	15	25	92	11	70	9	182	98	344	353	8.0
76-0125-71-838042690305	125	AS2129D	121	56	15	25	92	14	70	9	201	114	359	387	11
76-0150-71-838042690305	150	AS2129D	146	56	15	25	92	14	70	9	214	127	370	411	12
76-0200-71-838042690305	200	AS2129D	197	60	18	31	92	17	70	9	245	158	551	479	19
76-0250-71-838042390303	250	AS2129D	247	68	20	38	130	22	102	11	283	194	394	572	32
76-0300-71-838042390303	300	AS2129D	297	78	20	38	130	22	102	11	308	219	461	630	45