

Resilient seated swing check valve
 Face to face dimension to AS 4794-2001
 Flanges and drilling to AS 4087 Fig. B5

Component list

- | | | | |
|-----------|-----------|----------------|------------|
| 1. Lever | 3. Lever | 5. Eyebolt | 7. Washer |
| 2. Weight | 4. Spring | 6. Hexagon nut | 8. Bracket |

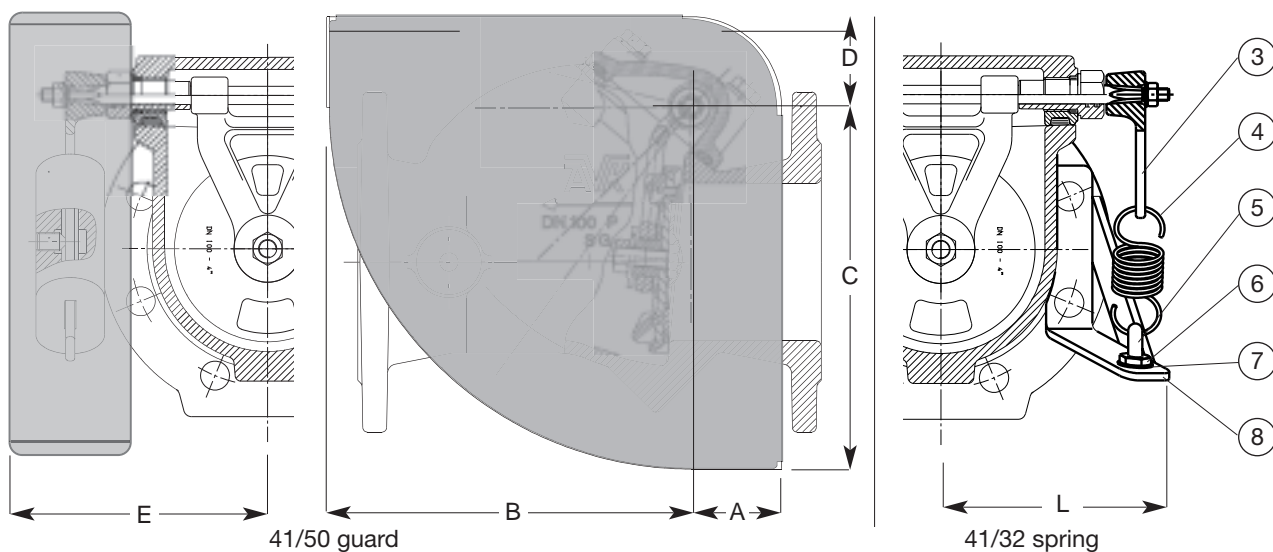
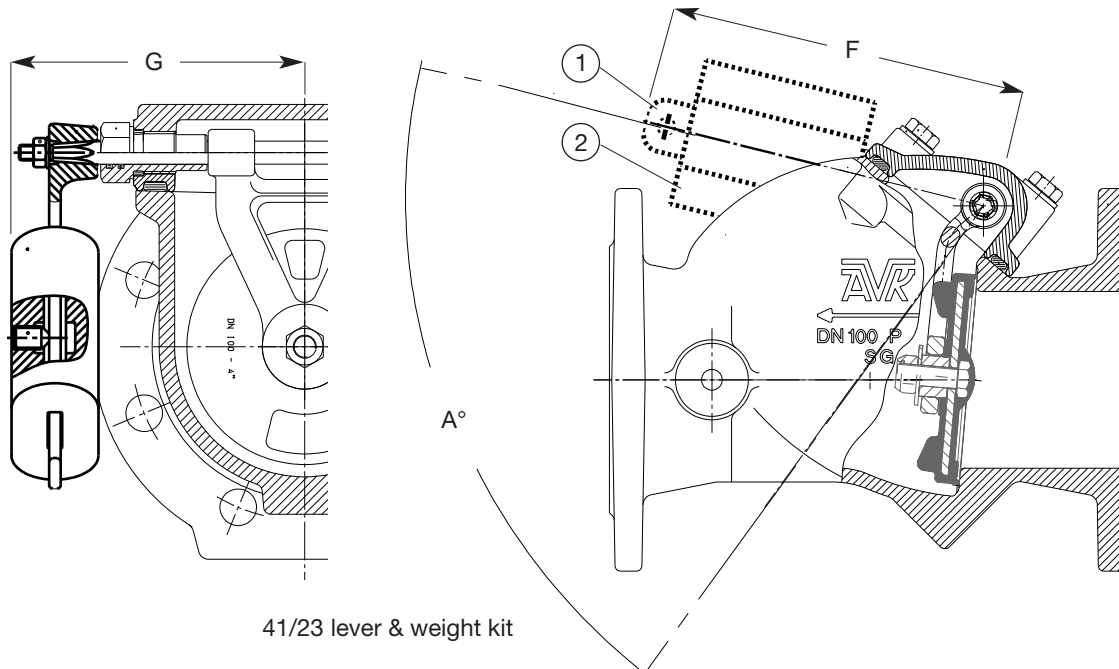

DN	Lever & weight kit Ref.nos.	F mm	G mm	A°	Weight kilos (theoretical)	Spring kit Ref.nos.	L mm	Weight kilos (theoretical)	Guard kit Ref.nos.	A mm	B mm	C mm	D mm	E mm	Weight kilos (theoretical)
80	41-080-23000	165	140	65°	2.6 (2.5)	41-080-32000	144	0.8	41-080-50600	49,5	159,5	159,5	49,5	170	2.2
100	41-100-23000	200	155	65°	5.2 (2.5)	41-100-32000	141	0.9	41-100-50600	49,5	194,5	194,5	49,5	180	3.0
150	41-150-23000	250	200	68°	5.2 (5.0)	41-150-32000	184	1.3	41-150-50600	59,5	224,5	224,5	59,5	225	3.5
200	41-200-23000	300	230	71°	12.5 (5.0)	41-200-32000	217	1.5	41-200-50600	59,5	289,5	289,5	59,5	250	4.5
250	41-300-23000	550	405	58°	12.5 (8.5)	41-300-32000	441	3.3	41-300-50600	82,5	558,0	558,0	82,5	420	10.2
300	41-300-23000	550	405	58°	12.5 (8.5)	41-300-32000	441	3.3	41-300-50600	82,5	558,0	558,0	82,5	420	10.2

All dimensions ± 2 mm



Resilient seated swing check valve
Face to face dimension to AS 4794-2001
Flanges and drilling to AS 4087 Fig. B5

Use:

For potable water and sewage to max. 60°C

Tests:

Hydrostatic test to AS 4794-2001
 Seat: 16 bar
 Body: 24 bar

Optional extras:

Lever and spring kit
 Lever and weight:
 Mounted RHS as standard - can be mounted LHS on request
 Guard (41/50)
 Priming device

Materials:

Body, bonnet and hinge	Ductile iron to AS 1831 grade 500-7
Coating	Electrostatically applied epoxy resin to AS 4158 - Internally and externally
Shaft	Stainless steel to ASTM A276 Gr. 316
Bonnet gasket	EPDM rubber
Bushing	Copper alloy AS 1565 C83600
Hexagon bolt, washer and pin	Stainless steel A4
Resilient seated disc	EPDM rubber with a steel insert

Accessory kit:

Weight, hinge lever and weight	Ductile iron, GGG-50, to AS 1831 grade 500-7
Spring, washer, hexagon bolt and pin	Stainless steel A2
Guard	FE 360 B to W. no. 1.0037

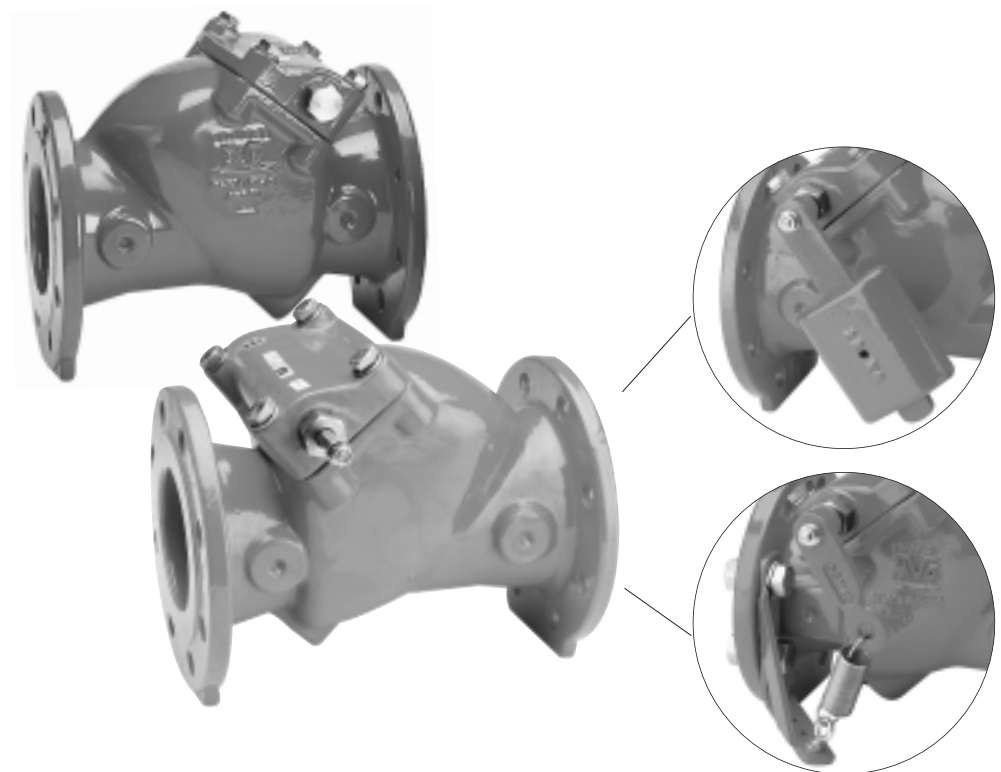

The designs, materials and specifications shown are subject to change without notice due to our continuing program of product development.

AVK Australia Pty Ltd
 7 Rosberg Road, Wingfield, SA 5013 Australia
 Tel: +61 8 8359 6166
 Fax: +61 8 8359 6417
 e-mail: avk@aquagas.com.au

3N4100BQ
 Dec. 2002



Resilient seated swing check valve free acting or with lever and weight
Face to face dimension to AS 4794-2001
Flanges and drilling to AS 4087 Fig. B5

Component list

- | | | | |
|-----------------|-----------------|------------------|-------------|
| 1. Washer | 5. Washer | 9. Bonnet gasket | 13. Bushing |
| 2. Nylon spacer | 6. Hexagon bolt | 10. Body | 14. Shaft |
| 3. Bolt | 7. Hinge | 11. O-ring | |
| 4. Disc | 8. Bonnet | 12. O-ring | |

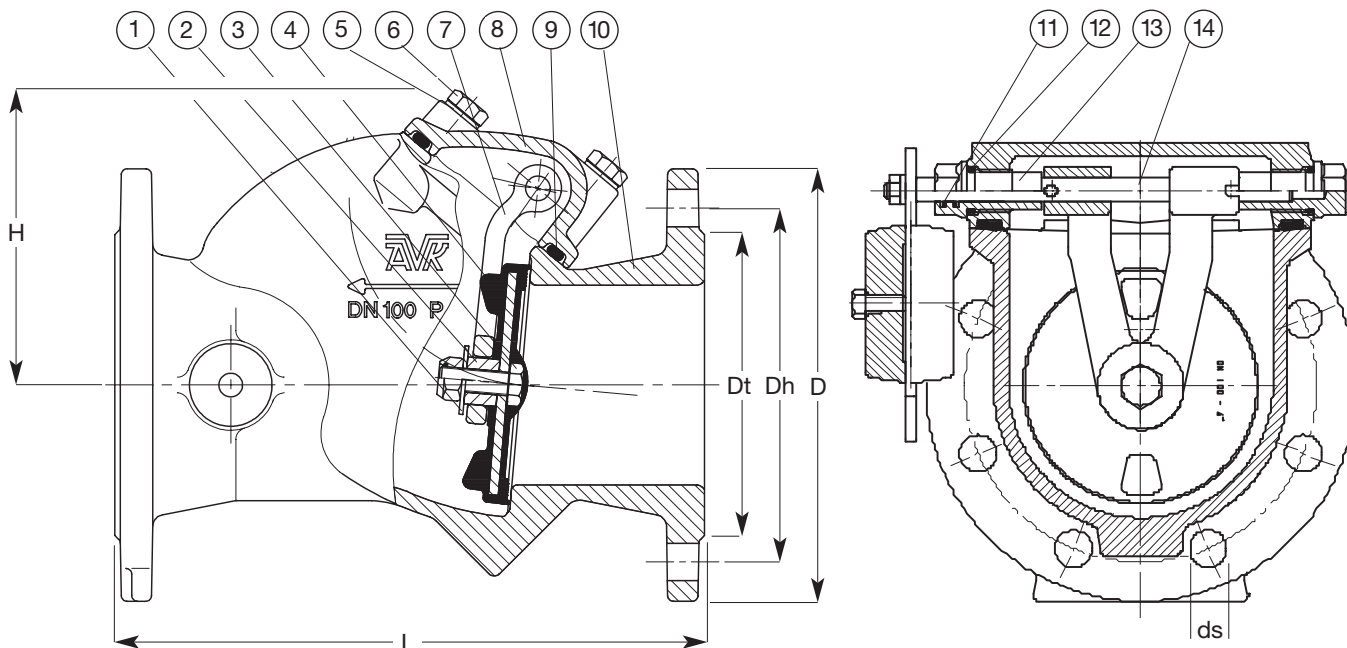

With free acting

Ref.nos.	DN	L mm	H mm	Dt mm	D mm	Dh mm	ds mm	Holes	Weight kilos (theoretical)
41-080-81027	80	260	140	122	185	146	18	4	20
41-100-81027	100	330	150	154	215	178	18	4	26
41-150-81027	150	410	195	209	280	235	18	8	51
41-200-81027	200	540	230	264	335	292	18	8	83
41-250-81027	250	640	270	328	405	356	22	8	183
41-300-81027	300	700	300	376	455	406	22	12	231

With lever & weight

Ref.nos.	DN	L mm	H mm	Dt mm	D mm	Dh mm	ds mm	Holes	Weight kilos (theoretical)
41-080-82027	80	260	140	122	185	146	18	4	20
41-100-82027	100	330	150	154	215	178	18	4	26
41-150-82027	150	410	195	209	280	235	18	8	51
41-200-82027	200	540	230	264	335	292	18	8	83
41-250-82027	250	640	270	328	405	356	22	8	183
41-300-82027	300	700	300	376	455	406	22	12	231

Resilient seated swing check valve with solid rubber disc and integrated hinge.
 Face to face dimension to AS 4794-2001
 Flanges and drilling to AS 4087 Fig. B5

Component list

- | | | | |
|------------------|------------------|------------|-----------|
| 1. Washer | 4. Disc | 7. Body | 10. Shaft |
| 2. Hexagon screw | 5. Bonnet | 8. Bushing | |
| 3. Disc insert | 6. Bonnet gasket | 9. O-ring | |

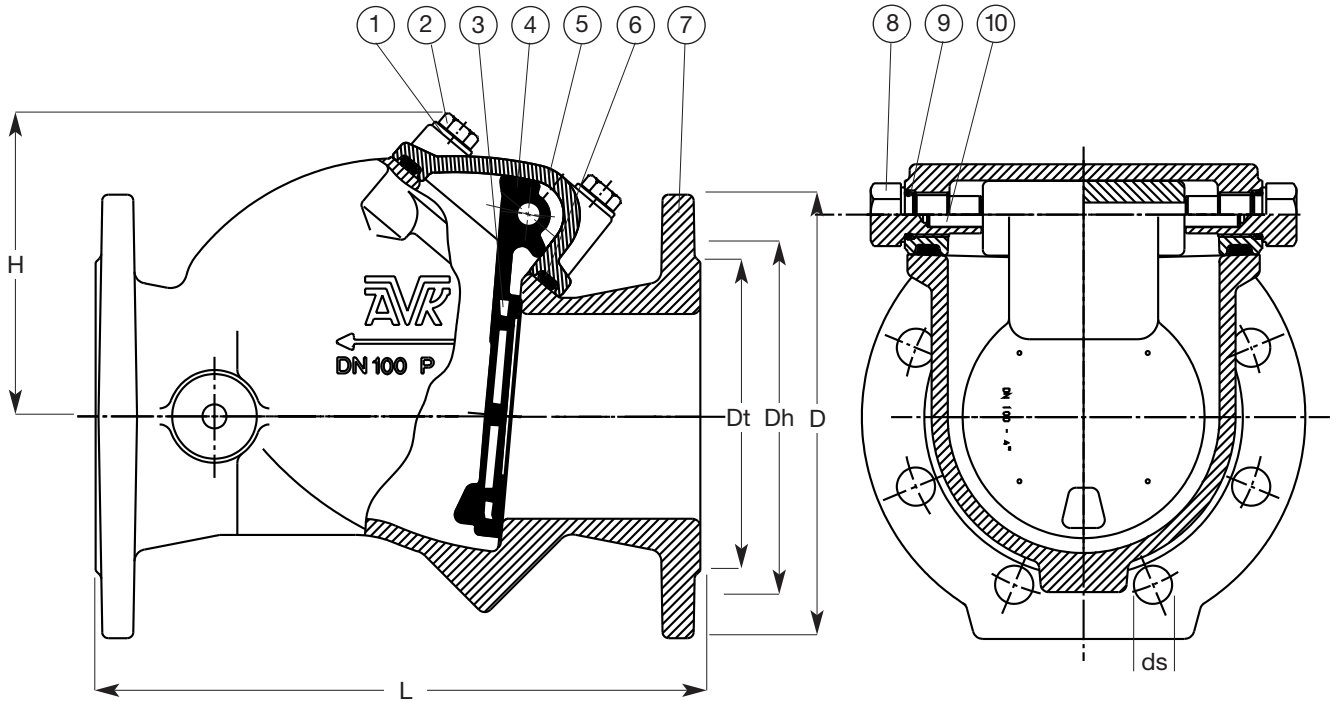

With solid rubber disc and integrated hinge

Ref.nos.	DN	L mm	H mm	Dt mm	D mm	Dh mm	ds mm	Holes	Weight kilos (theoretical)
41-080-89027	80	260	140	122	185	146	18	4	15
41-100-89027	100	330	150	154	215	178	18	4	20
41-150-89027	150	410	195	209	280	235	18	8	40
41-200-89027	200	540	230	264	335	292	18	8	70