

**Flange drilling to AS 4087 fig. B5**  
**Series 53/35 DN 50 & 65 PN 10 (face to face dimension to DIN 3202 - F6)**  
**Series 53/50 DN 80 - 300 PN 16 (face to face dimension to AS 4794)**

**Use:**

For non-potable water, sewage and neutral liquid applications  
 Valve designed for use up to 70°C  
 Note: Always observe pipe material recommended operating temperatures

**Tests:**

According to ISO 5208:  
 Seat: 1.1 x PN  
 Body: 1.5 x PN  
 Low pressure test according to LGA-standards

**Options:**

Polyurethane ball for special applications  
 Series 53/35 DN 350 to 600 PN10 rated

**Materials:**

Body and cover	Ductile iron to AS 1831 grade 400-12
Coating	Electrostatically applied epoxy resin - internally and externally to AS/NZS 4158
Cover gasket	NBR O-ring
Ball	DN 50 to 100: Aluminium, vulcanised with NBR rubber  DN 150 to 300: Grey cast iron, vulcanised with NBR rubber
Bolts, nuts and washers	Stainless steel: DN 50 & 65 - A2 (SS 304) DN 80 to 300 - A4 (SS 316)

Note: Flange holes for DN 50 & 65 are drilled and tapped



**Series 53/50**  
DN 80 - 300



**Series 53/35**  
DN 50 & 65

AVK Australia's website contains the latest product information and data sheets.

Designs, materials and specifications shown are subject to change without notice due to our continuing program of product development.



AVK Australia Pty Ltd  
 559A Grand Junction Road, Wingfield, SA 5013 Australia  
 Tel: +61 8 8368 0900  
 Fax: +61 8 8368 0970  
 E-mail: info@avkvalves.com.au  
 www.avkvalves.com.au

Copyright© AVK Group A/S 2011

3N5350DQ  
 February 2011

Flange drilling to AS 4087 fig. B5  
 Series 53/35 DN 50 & 65 PN 10 (face to face dimension to DIN 3202 - F6)  
 Series 53/50 DN 80 - 300 PN 16 (face to face dimension to AS 4794)

### Component list

- |                    |         |
|--------------------|---------|
| 1. Cover           | 4. Body |
| 2. Bolt/nut/washer | 5. Ball |
| 3. Gasket          |         |

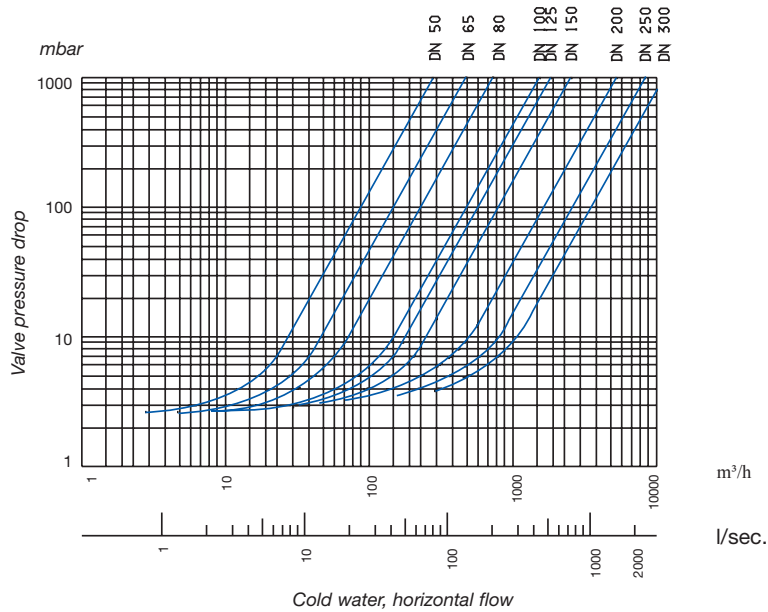
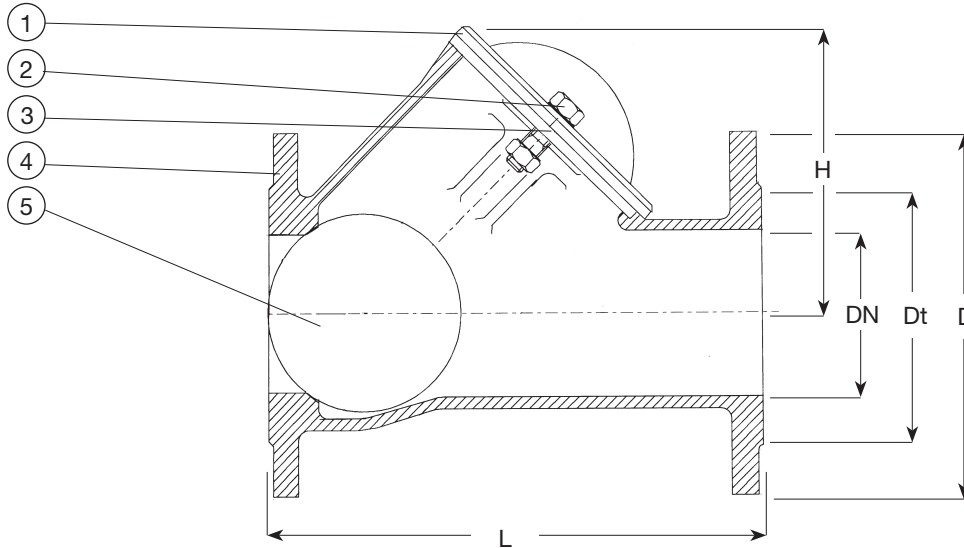

Ref. nos.	DN	L mm	Dt mm	D mm	H mm	Ball mm	Weight kilos
53-050-355007	50	200	98	165	101	60	7.5
53-065-355007	65	230	118	185	148	95	12.0
53-080-505012	80	260	133	200	148	95	13.0
53-100-505012	100	330	159	220	182	120	18.0
53-150-505012	150	410	209	285	251	175	37.5
53-200-505012	200	540	268	340	333	240	70.0
53-250-505012	250	640	319	400	406	300	128.0
53-300-505012	300	700	367	455	480	360	187.0

Note: Series 53/35 DN 350 to 600 PN10 rated available on application