

**Double orifice air release valve PN 16 & PN 25**  
**Built in accordance with AS 4956**  
**Inlet flange drilling to AS 4087 B5 (PN 16) & AS 2129 Table F (PN 25)**

**Use:**

For water (not sewage) and neutral liquid applications  
 Valve designed for use up to 70°C  
 Where applicable; for AS 4020 compliance, max temp = 40°C  
 Note: Always observe pipe material recommended operating temperatures  
 Working pressure: min. 0.1 bar  
                           max. 16 bar - PN 16  
                           max. 25 bar - PN 25

**Tests:**

Hydraulic test: 1.5 x PN

**Options:**

Isolating: gate valve or butterfly valve  
 Pipe outlet connection  
 Inflow check valve  
 Vented non return valve (surge-alleviation)

**Materials:**

Body, bonnet, cowl	Ductile iron, 500-7 to AS 1831
Float (large orifice)	ABS Plastic
Float guides	ABS Plastic
Float lever	ABS Plastic
Seal support ring	ABS Plastic
Seals	EPDM WBS listed
Coating	FBE to AS 4158
Fasteners	316 Stainless steel

**Features:**

Cylindrical large orifice float  
 Embodies unique aerokinetic feature  
 Does not shut prematurely  
 Release of large volumes of air during pipeline filling  
 Allows inflow of large volumes of air when pipe is emptied  
 Release of air under pressure  
 Low maintenance  
 Streamlined air flow



AVK Australia's website contains the latest product information and data sheets.

Designs, materials and specifications shown are subject to change without notice due to our continuing program of product development.



AVK Australia Pty Ltd  
 559A Grand Junction Road, Wingfield, SA 5013 Australia  
 Tel: +61 8 8368 0900  
 Fax: +61 8 8368 0970  
 E-mail: info@avkvalves.com.au  
 www.avkvalves.com.au  
 Copyright© AVK Group A/S 2009

3N851XIQ  
 December 2009

**Double orifice air release valve PN 16 & PN 25**  
**Built in accordance with AS 4956**  
**Inlet flange drilling to AS 4087 B5 (PN 16) & AS 2129 Table F (PN 25)**

**Component list:**

- |                      |                        |                     |                     |
|----------------------|------------------------|---------------------|---------------------|
| 1. Cowl              | 6. Float guide         | 11. Orifice cover   | 16. Sealing face    |
| 2. Cover             | 7. Body (low pressure) | 12. Orifice bracket | 17. Float and lever |
| 3. Seat ring         | 8. Screw               | 13. Gasket          | 18. Float           |
| 4. Seat support ring | 9. Hexagon nut         | 14. Fulcrum pin     | 19. Body            |
| 5. Float             | 10. Screw, h/soc. cap  | 15. Adjusting screw | 20. Gasket          |

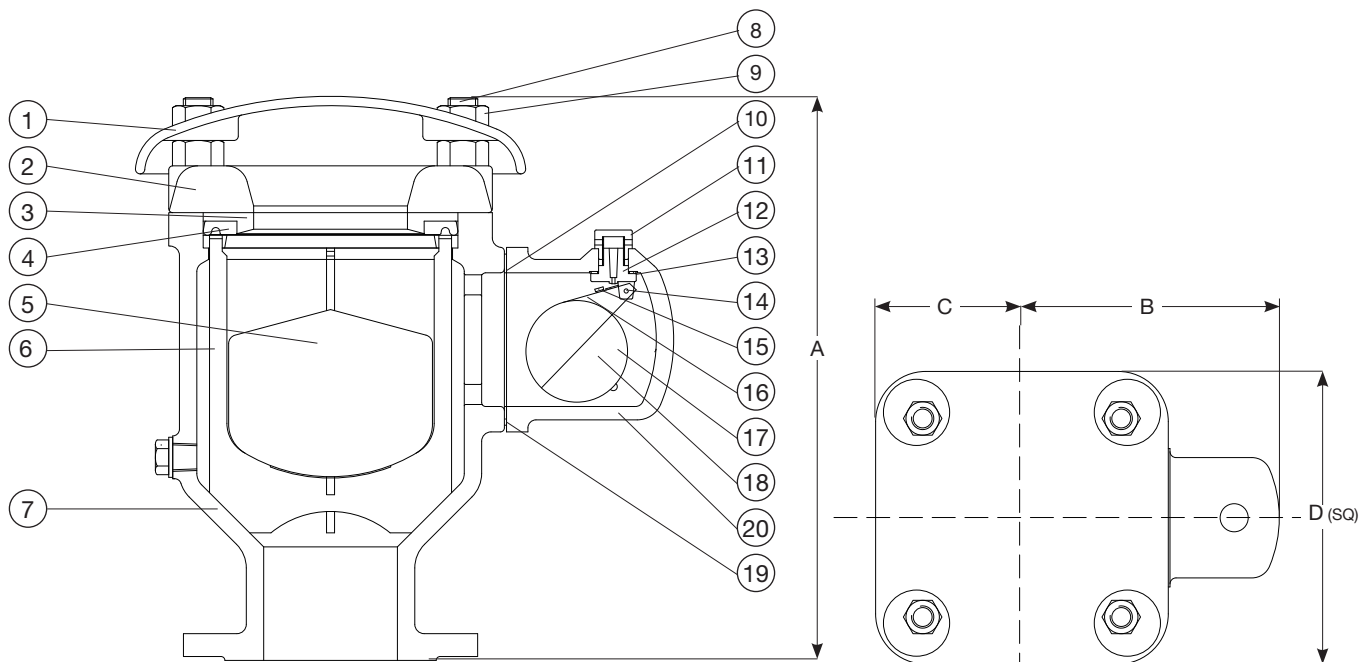

**PN 16 - Flange Drilling AS 4087 B5**

Ref. nos.	DN	A mm	B mm	C mm	D mm	Weight kilos
851-050-20523	50	256	212	81	162	20.4
851-080-20523	80	327	239	111	222	31.7
851-100-20523	100	410	259	146	292	51.7
851-150-20523	150	410	259	146	292	57.2

**PN 25 - Flange Drilling AS 2129 Table F**

Ref. nos.	DN	A mm	B mm	C mm	D mm	Weight kilos
851-050-10923008	50	256	212	81	162	22
851-080-10923008	80	327	239	111	222	33
851-100-10923008	100	410	259	146	292	53
851-150-10923008	150	410	259	146	292	59

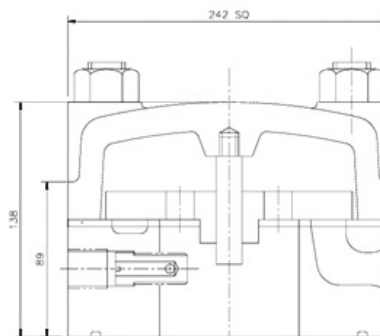

Vented non-return kit that can be fitted to a standard valve